



FOR THE SPECIAL NEEDS OF SENSITIVE SKIN

Seraman™ sensitive / Seraman™ sensitive foam

MODERN & SKIN-FRIENDLY HAND & BODY CLEANSING WASH

Optimal hand and body cleansing developed for sensitive skin.

- MODERN surfactant combination
- SKIN-FRIENDLY - Dye and fragrance-free
- AVAILABLE as foam or liquid soap



Seraman™ sensitive / Seraman™ sensitive foam

Modern and skin-friendly hand & body cleansing wash.

PRODUCT CHARACTERISTICS

PRODUCT PERFORMANCE	BENEFITS FOR THE USER
Particularly skin-friendly surfactant combination containing APG (alkyl polyglucoside)	Suitable for individuals with sensitive skin
Dye and fragrance-free Use of an extremely skin-friendly preservative	Low allergenic potential, less skin irritation
APG is made from renewable raw materials such as maize, potatoes, wheat and natural fats including coconut and palm kernel oil	Extremely environmentally friendly since it is easily degradable and residue-free
Seraman™ sensitive foam: Foam application Stable creamy foam - economical	Easy to rinse off Extremely gentle on the skin Product savings of up to 70% and reduced water consumption

INSTRUCTIONS FOR USE

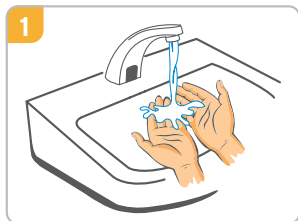

Moisten hands with water.



Pump the product once or twice onto the palm of your hand.



Rub your palms together to create a lather. Then wash your hands thoroughly.

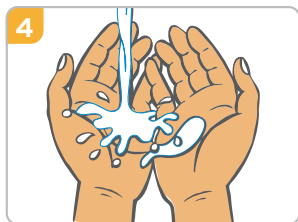

Rinse your hands with water.

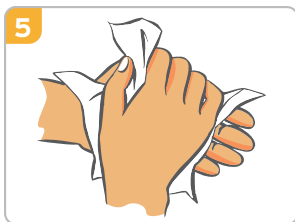

Thoroughly dry your hands with a disposable towel.

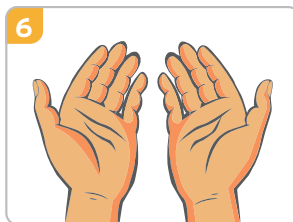

Your hands are now clean.

ORDERING INFORMATION

PRODUCT	PACKAGING UNIT	ORDER CODE
Seraman™ sensitive	24 x 500ml	XXXXXX
Seraman™ sensitive	12 x 1L	XXXXXX
Seraman™ sensitive	6 x 750ml	XXXXXX
Seraman™ sensitive foam	6 x 750ml	XXXXXX

AREAS OF APPLICATION

- For washing hands, body and hair
- May be used to pre-wash hands and forearms prior to surgical hand rubbing with an alcohol based hand rub.
- Suitable for use in the catering and food-processing industries
- For individuals with sensitive skin such as, for example, children, the elderly and nursing staff

EXPERT REPORT

We will be happy to send you our latest expert report upon request.

INGREDIENTS

Composition Seraman™ sensitive washing lotion:

Aqua, Sodium Laureth Sulfate, PEG-7-Glyceryl Cocoate, Lauryl Glucoside, Ammonium Sulfate, Laureth-2, Sodium Benzoate, Sodium Citrate.

Composition Seraman™ sensitive foam:

Aqua, Sodium Laureth Sulfate, PEG-7-Glyceryl Cocoa- te, Lauryl Glucoside, Laureth-2, Sodium Benzoate.

RECOMMENDED APPLICATION

When should I wash my hands?

- When they are visibly soiled with blood or other body fluids
- After suspected contact with potentially spore-foaming pathogens, including Clostridium difficile
- After using the toilet



ALWAYS READ THE LABEL AND PRODUCT INFORMATION BEFORE USE.

ECOLAB EUROPE
Hofwiesenstrasse 349
CH-8050 Zürich
Switzerland

ECOLAB DEUTSCHLAND GmbH
Ecolab-Allee 1
40789 Monheim am Rhein
Germany

ECOLAB®

www.ecolab.com